



## Healthy practice in the heart of the city

By Meagan Shand, BSc (Health Promotion)

**T**he new LifeCare Dental Citiplace is a pocket of Zen in the chaos of a busy city railway station. Located on the upper concourse of Perth's Central Station, the centre is an adjunct to the LifeCare Dental Forrest Chase practice, a well established Emergency Dental Service located on the opposite side of the road 200 metres across an elevated walkway.

The LifeCare Dental Forrest Chase practice has been a landmark in Perth for over 19 years and is the longest standing emergency dental service in WA. Located in the heart of the city, the practice is open from 8am to 8pm every day of the week and is easily accessible by bus, road or rail. The Practice services the whole of the Perth Metropolitan area, has two centres, a

laboratory, 11 surgeries and employs 17 dentists, 3 technicians, 30 nurses and assistants and 18 administration staff. Many of the clinicians and staff are multilingual, offering Mandarin, Vietnamese, Japanese, Indi, Italian and Romanian translation.

Kathy Clarkson manages this remarkable centre and has been with the practice for over 12 years. When asked about the new rooms, Kathy said, "although we had to build the new centre due to redevelopment of the city concourse, the change was somewhat overdue. The centre was out of date, small and cluttered; the installations were looking well used."

The new cosmopolitan practice is bright, clean and modern. "Our patients all comment on how pretty the new rooms look,"

Kathy said, "they love the Aboriginal Artworks featured throughout the surgery". The colourful indigenous artworks are from the private collection of principal and founding dentist Dr Alex Negoescu. The original artworks, juxtaposed with whisker white coloured walls, Brazilian Nut Expona Super-plank Art Vinyl Planking floors, a Corian Earth front reception with feature Platinum colored glass insert, and Elko chit-chat waiting chairs, give the practice a contemporary feel on entry.

"One of the best features of the new design is that admin and reception are separated from the treatment rooms. Although there are now 6 treatment rooms in this centre, patients seldom pass each other in the corridor, creating a personal and relaxed experience."



The corridor features a refresh area with custom mirror and splashback, entry to the treatment rooms are through easy access sliding doors with large chrome handles. The rooms are uncluttered and bright, with natural light flooding through large geometric windows that look out onto the cityscape, creating a fresh and healthy work space for staff.

The consultants from Ego Squared Design have made good use of the space, creating room for two extra surgeries. Each treatment room features the latest dental technology and equipment including A-dec Radius 1040 and Planmeca integrated patient chairs and instrument delivery units, HP Flat Screen Computers and 22 inch roof mounted LCD monitor screens. There is a large 7.2 square metre sterilisation room with floor to ceiling gloss white overhead storage cabinets, metallic platinum coloured glass splash backs, Gunship metallic



Photography by Karrina Liverist, Third Eye Photography



cabinet doors and soft close drawers with stainless steel handles. Statim and Mocom Millennium B autoclaves complete the business end of the area. A stand alone laboratory is located 100 metres from the main building. The 22.5 square metre “annex” accommodates 3 technicians in 3 rooms, 2 separate working spaces and a reception for service and delivery.

Featured throughout the practice are seamless durable Arctic white Corian bench tops with 150mm covered upstands, a trademark of local fit out company, Dentpro. “We like to buy local, so we engaged a number of WA dental specialist services to complete the job,” Kathy said. “Bill from Dentpro has worked with us



## Summary

### The Practice

Principal	Dr Alex Negoescu Life Care Dental
Type of Practice	General
Location	Perth, Western Australia
Size	143 square metres
No of chairs	6

### The Team

Design	Ego Squared Design Consultants
Senior Designer	Natasha Connor
Construction	Dentpro Dental Fit-Out Specialists
Project Manager	Bill Elsegood

### Equipment

Dental Units	Planmeca and A-dec Radius 1040
Sterilisation	Mocom Millennium B+, Statim 5000
X-Ray	Planmeca
Compressor	Cattani
Suction	Cattani Turbo Smart
Software	PracticeWorks

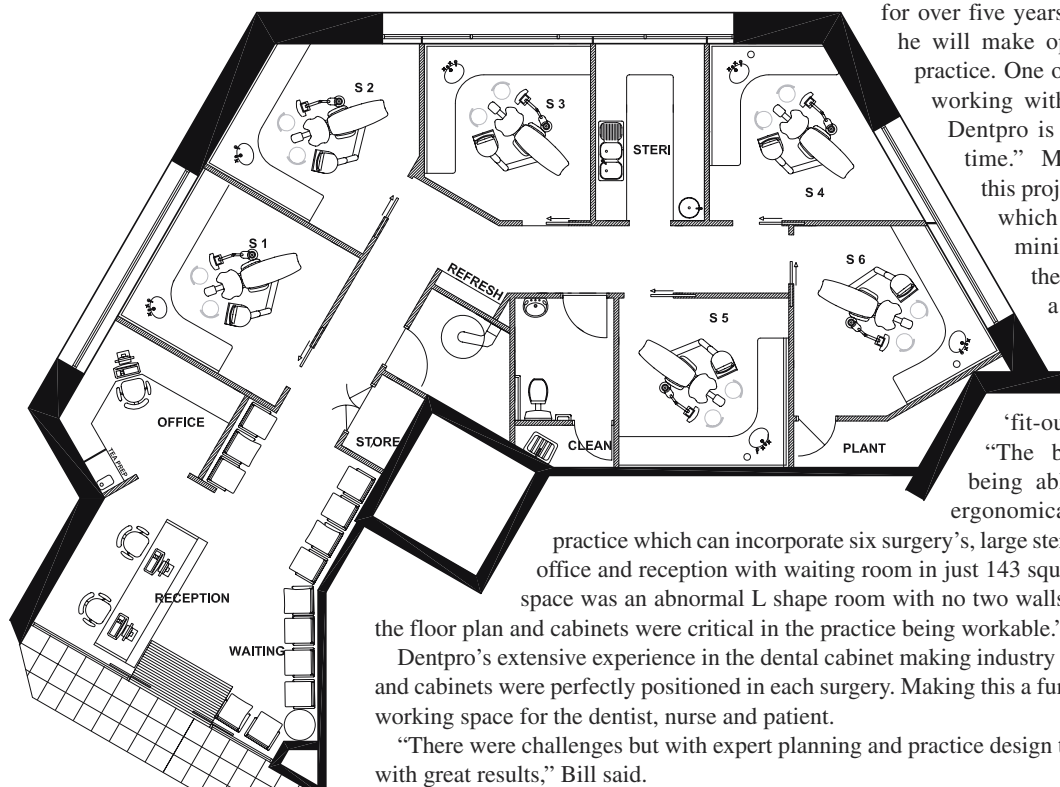

for over five years now and we trust that he will make optimal choices for our practice. One of the great things about working with Bill and the team at Dentpro is that there is no downtime.” Most of the work for this project was done after hours which meant there was minimal interference with the running of the practice, a signature service of the company.

The project manager and a dental ‘fit-out’ specialist, Bill said “The biggest challenge was being able to comfortably and ergonomically design and build a

practice which can incorporate six surgery’s, large steri, dedicated OPG room, office and reception with waiting room in just 143 square metres. The original space was an abnormal L shape room with no two walls parallel. The design of the floor plan and cabinets were critical in the practice being workable.”

Dentpro’s extensive experience in the dental cabinet making industry helped ensure the chairs and cabinets were perfectly positioned in each surgery. Making this a functional but comfortable working space for the dentist, nurse and patient.

“There were challenges but with expert planning and practice design the project ran smoothly with great results,” Bill said.